

# Salsbury & Associates Insurance Services, Inc.

3155 Kearney St., #240 Fremont, CA 94538

Bus: (510) 413-0270 Fax: (510) 413-0275

www.salsburyins.com

## E.I.F.S.

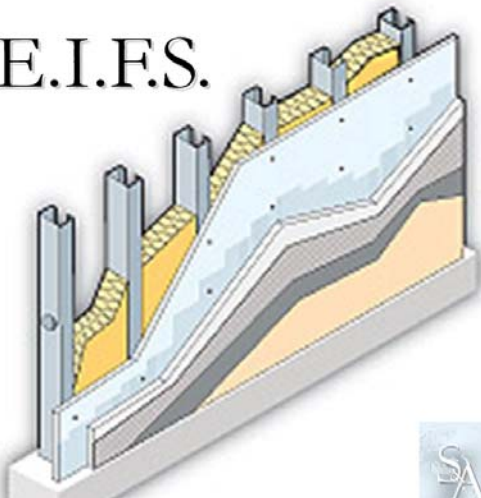

We've got you covered.



## Exterior Insulation Finishing Systems

**Salsbury & Associates** developed an **exclusive insurance program** for commercial E.I.F.S. contractors. Our program was developed to meet the requirements asked for by General Contractors and Building Owners nationwide.

In 2006, we announced split rates so you only pay for what you use. This allows your insurance premiums to be more appropriate and cost effective.

### Policy Highlights:

- Per Occurrence Policy
- Increased Coverage Limits (\$1,000,000 & \$2,000,000)
- Blanket Additional Insured Endorsements (CG2010 11/85)
- Blanket Waiver of Subrogation Endorsements
- Blanket Primary & Non-Contributory Wording Endorsements
- Split Rates Now Available! (Drywall, EIFS, Painting & Plastering)
- Excess Liability Coverage Available (Up to \$25,000,000 Available)

**Salsbury & Associates is a full insurance service provider and can facilitate all your insurance needs. Call us today to receive an E.I.F.S. quotation and more!**

- Workers Compensation
- Commercial Automobile
- Commercial Property & Equipment Coverage
- Employee & Executive Benefits
- And More!

**Salsbury & Associates Insurance Services, Inc.**

**...Beyond Insurance**

### Contact:

Allen Salsbury

(510) 413-0270 ext. 202

[asalsbury@salsburyins.com](mailto:asalsbury@salsburyins.com)

