

Dryvit Systems Accessories

DS451

DRYVIT VENT ASSEMBLY™, STARTER STRIP™, TRACK, VENT TRACK™, DRAINAGE TRACK™, AND DRAINAGE STRIP™

Vent Assembly

Dryvit Vent Assembly is a 51 mm X 152 mm X 305 mm (2 in X 6 in X 12 in) assembly of formed aggregate matrix material encased in aged expanded polystyrene (EPS) and is configured to accept the Dryvit Vent Track. It is required at the base of horizontal compartments and is capable of draining water and passing air. The Vent Assembly is a component of the Infinity® and Outsulation® MD Systems®, and is packaged 16 pieces to a case.

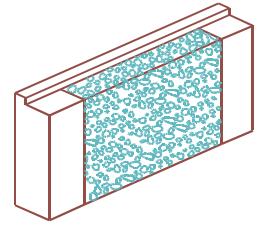

Starter Strip

Dryvit Starter Strip is a 51 mm X 152 mm X 1.2 m (2 in X 6 in X 48 in) piece of aged expanded polystyrene configured to accept the Dryvit Track and Vent Track. It is required in the Infinity and Outsulation MD systems, and is packaged 27 pieces to a case.

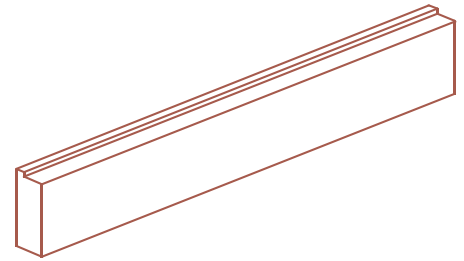

Track, Vent Track

A “J” shaped PVC track complying with ASTM D 1784 and ASTM C 1063 located above the Dryvit Starter Strip. Vent Track has an opening and is placed directly above the Vent Assembly. Track and Vent Track are used in the Infinity and Outsulation MD systems. These items are sold by the case, and each case contains 40, 10 ft long pieces.

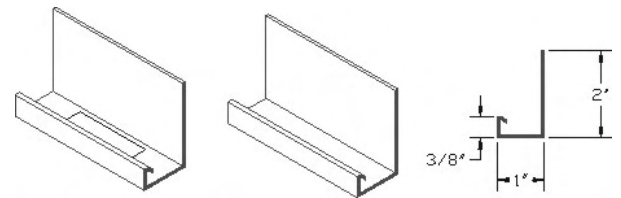

Drainage Track

UV treated PVC perforated “J” channel with weep holes, complying with ASTM D 1784 and ASTM C 1063. Shall be one of the following:

1. Starter Trac STWP - without drip edge by Plastic Components, Inc.
2. Starter Trac STDE - with drip edge by Plastic Components, Inc.
3. Universal Starter Track by Wind-lock Corporation
4. Sloped Starter Strip with Drip by Vinyl Corp.

Drainage Track is used in the Outsulation Plus® MD, Outsulation® RMD, and Outsulation® SMD systems.

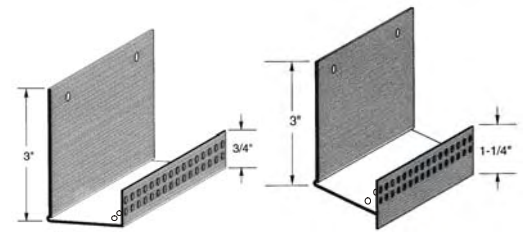

Drainage Strip

A corrugated high impact polystyrene material, which is used to provide drainage at the base of walls, heads of windows and floor line expansion joints. It is packaged in cases with 6 rolls per case; totaling 1500 lineal feet per case. Drainage Strip is used in the Outsulation Plus® MD, Outsulation® RMD, and Outsulation® SMD systems.

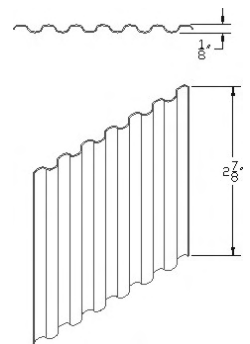

Unless noted, all accessories are available through your Dryvit distributor and are covered by the appropriate warranty for the system used.

Dryvit Systems, Inc.
One Energy Way
P.O. Box 1014
W. Warwick, RI 02893
(800) 556-7752
www.dryvit.com

Information contained in this product sheet conforms to the standard detail recommendations and specifications for the installation of Dryvit Systems, Inc. products as of the date of publication of this document and is presented in good faith. Dryvit Systems, Inc. assumes no liability, expressed or implied, as to the architecture, engineering or workmanship of any project. To ensure that you are using the latest, most complete information, contact Dryvit Systems, Inc.

dryvit
An RPM Company