

DRYVIT MD SPACER™

A Polyethylene Spacer for Use with the Outsulation® SMD System™ and Cement Board MD System®

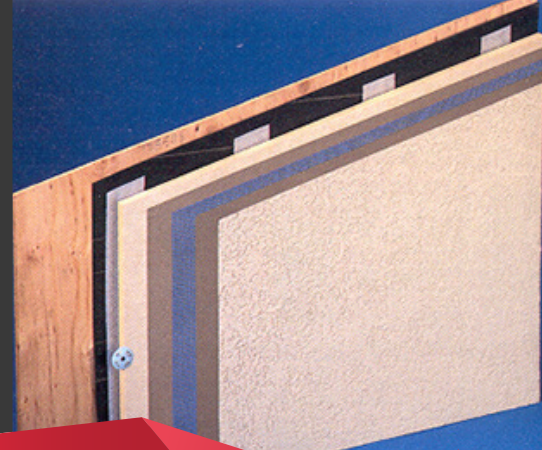

PRODUCT DESCRIPTION AND USES

Dryvit MD Spacer is a 1/8 in (3.2 mm) thick by 3 in (76 mm) wide polyethylene foam product used to create a drainage plane for the Outsulation SMD System and Cement Board MD System. It is applied vertically on the wall every 16 in (410 mm) on-center and at all changes in wall directions. In the Outsulation SMD System, it creates a space between the insulation board and the air/water-resistive barrier. For the Cement Board MD System, it creates a space between the air/water-resistive barrier and the cement board.

FEATURES & BENEFITS

FEATURE

- 3 in (76 mm) wide
- Polyethylene foam product
- Supplied in bags containing 16 rolls

BENEFIT

- Cut to size
- Easy to use
- Easy to store

INSTALLATION

In the Outsulation SMD System and the Cement Board MD System, the Dryvit MD Spacer is fastened with corrosion resistant staples or roofing nails through the water-resistive barrier and into the substrate or framing. Please refer to the Outsulation SMD System Application Instructions, DS123, or the Cement Board MD Finish System Specification, DS191, for more detailed instructions for the respective system.

TYPICAL PHYSICAL PROPERTIES

Test	Results	Units	Test Method
Density	1.2	lbs/ft ³	PPP-C-1752 B
Water Absorption (4.3 psi)	0.02	lbs/ft ²	PPP-C-1752 B
Flexibility	Pass	-	PPP-C-1752 B
Contact Corrosivity	No induced corrosion	-	PPP-C-1752 B
Dusting and Breakdown	0.1	%	PPP-C-1752 B
Abrasion	Pass	-	PPP-C-1752 B

DS 484

COVERAGE

MD Spacers are supplied in bags containing 16 rolls. Each roll is 100 ft (30 m) long x 3 in (76 mm) wide. The total lineal feet per bag is 1600 lf (480 m).

STORAGE

Dryvit MD Spacer must be stored out of direct sunlight and protected from weather until ready to install.

Information contained in this product sheet conforms to the standard detail recommendations and specifications for the installation of Dryvit Systems, Inc. products as of the date of publication of this document and is presented in good faith. Dryvit Systems, Inc. assumes no liability, expressed or implied, as to the architecture, engineering or workmanship of any project. To ensure that you are using the latest, most complete information, contact Dryvit Systems, Inc.

For more information on [Dryvit Systems](#) or [Continuous Insulation](#), visit these links.

Printed in USA. Issued 10-04-16
©Dryvit Systems, Inc. 2003



Dryvit Systems, Inc.
One Energy Way | West Warwick, RI 02893
(800) 556-7752 | www.dryvit.com